

RAVELLE PENDANT 12"

ASSEMBLY AND INSTALLATION INSTRUCTIONS

ENGLISH

RAVELLE PENDANT 12"

PARTS INCLUDED

- (A) Mounting Strap (1)
- (B) Mounting Loop (1)
- (C) Mounting Screws (2)
- (D) 18" Connection Rods (2)
- (E) Canopy (1)
- (F) Canopy Ring (1)
- (G) 6" Connection Rods (2)
- (H) 12" Connection Rods (2)
- (I) Connectors (5)
- (J) Top Screws (4)
- (K) Bottom Screws (4)
- (L) Plastic Washers (8)
- (M) Glass Ring (1)
- (N) Glass Cylinder (1)
- (O) Shade Holder (1)
- (P) Bulbs (4)
- (Q) Wire Nuts (3)

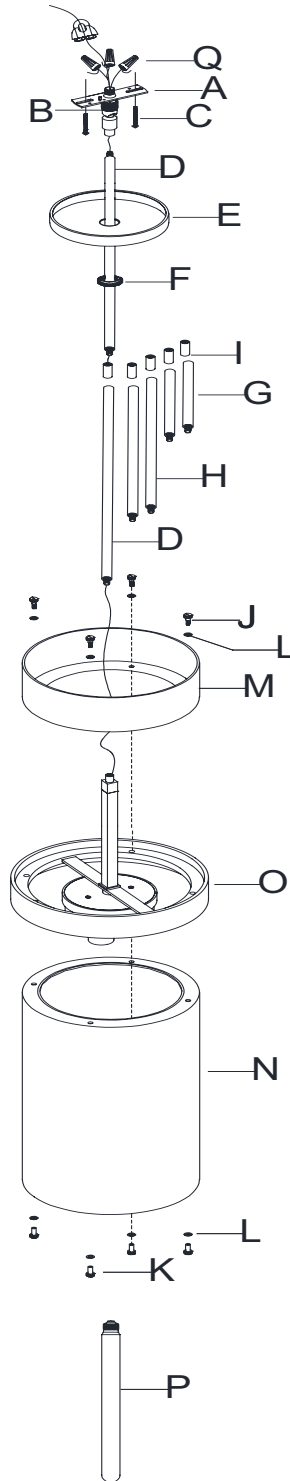

IMPORTANT: PLEASE READ

PLEASE FOLLOW THE ASSEMBLY INSTRUCTIONS CLOSELY. IMPROPER ASSEMBLY OR INSTALLATION CAN RESULT IN PERSONAL OR PROPERTY DAMAGE. MOUNTING HARDWARE HAS BEEN PROVIDED FOR MOUNTING DIRECTLY TO A JUNCTION BOX. UNIQUE OR ALTERNATIVE INSTALLATION METHODS MAY REQUIRE DIFFERENT MOUNTING HARDWARE, WHICH HAS NOT BEEN INCLUDED. ALWAYS CONSULT WITH A LICENSED ELECTRICIAN BEFORE INSTALLATION.

INSTALLATION BY A LICENSED ELECTRICIAN IS STRONGLY RECOMMENDED.

IMPORTANT SAFETY FEATURES

BULBS

This fixture has been rated for four (4) 60-watt maximum Type T incandescent lightbulbs or four (4) 9-watt maximum LED lightbulbs. To avoid the risk of fire, do not exceed the recommended wattage.

VAULTED CEILING COMPATIBILITY

This fixture is vaulted-ceiling compatible, up to a maximum ceiling slope of 20 degrees.

DIMMER-SWITCH COMPATIBILITY

This fixture is dimmer switch compatible and may be used with either a forward-phase or reverse-phase dimmer switch.

WARNINGS

All wires are connected. When unpacking, be careful not to pull wires, as damage may result. Do not connect electricity until the fixture is fully assembled. To reduce the risk of fire, electrical shock, or personal injury, always turn off fixture and allow it to cool prior to replacing the lightbulb. Do not touch or look directly at the bulb when fixture is illuminated. Keep flammable materials away from lit bulb.



WARNING: This product can expose you to chemicals including lead, which is known to the State of California to cause cancer and birth defects or other reproductive harm.

For more information, go to www.P65Warnings.ca.gov.

WARNING: STRANGULATION HAZARD

Keep cord at least 3 feet away from cribs, bassinets, and toddler beds. Keep out of reach of children under 3 years of age.

THIS PRODUCT IS NOT A TOY AND HAS NO PLAY VALUE.

INSTALL SAFETY CABLE:

1. Run safety cable through junction box and around structural member of building.
2. Wrap the safety cable around saddle (a), and secure with u-bolt (b) and hex nuts (c).

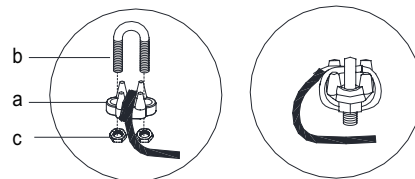

ASSEMBLY AND INSTALLATION**SHUT OFF THE MAIN ELECTRICAL SUPPLY FROM THE FUSE BOX OR CIRCUIT BREAKER PANEL.**

1. Carefully remove all parts from the box. Place on a clean, soft surface.
2. Remove Top Screws (J) and Plastic Washers (L) from Shade Holder (O). Remove Bottom Screws (K) and Plastic Washers (L) from Shade Holder (O).
3. Attach Glass Ring (M) to the top of Shade Holder (O) and secure with Plastic Washers (L) and Top Screws (J).
4. Attach Glass Cylinder (N) to the bottom of Shade Holder (O) and secure with Plastic Washers (L) and Bottom Screws (K).
5. Determine the desired hanging length of pendant. Connect the center rod on Shade Holder (O) to some or all Connection Rods (D) (G) (H) and Connectors (I) according to the length needed.
6. Feed wires through Connection Rods (D) (G) (H), Connectors (I) and Mounting Loop (B).
7. Unscrew Canopy Ring (F) from Mounting Loop (B). Slide Canopy Ring (F) and Canopy (E) onto Connection Rod 18" (D).
8. Screw Mounting Loop (B) onto the top nipple on Connection Rod 18" (D) by turning in a clockwise direction.
9. Attach Mounting Strap (A) to the ceiling outlet box and secure with Mounting Screws (C).
10. Connect the safety cable as shown in the diagram on the previous page.
11. Gently pull the wire from the ceiling outlet box and allow the wire to hang. Thread the wire through the center hole of Mounting Loop (B).
12. Wrap fixture ground wire (bare copper) around the green grounding screw. Tighten. Continue fixture ground wire and connect to supply ground wire (usually green or bare copper) using Wire Nut (Q).
NOTE: It is imperative that the fixture is grounded.
13. Connect fixture neutral wire (ribbed) to the supply neutral wire (usually white) using Wire Nut (Q).
14. Connect fixture hot wire (smooth with markings) to the supply

hot wire (usually black) using Wire Nut (Q).

CAUTION: Do not reverse the hot and neutral connections.

15. Make sure all wire connections are tight, then carefully tuck into the junction box.
16. Install Canopy (E) to Mounting Strap (A) and secure with Canopy Ring (F).
17. Insert Bulbs (P) into the sockets.
18. Restore power to outlet box and check operation of fixture.
19. Assembly is complete.

**ATTENTION:
ADJUSTING THE HANG HEIGHT**

Any adjustments or alterations to the fixture, cord, or overall hang height that differ from those detailed on RH.com will void the Laboratory Listing and Approvals (UL, ETL, CSA, etc.). If the listing is voided, this means the product may no longer be safe for use as modified. RH does not recommend modifying the product.

CARE INSTRUCTIONS

Do not use polishes or cleaners on the fixture.
Wipe clean with a soft, dry cloth.