

RAVELLE PENDANT 10"
ASSEMBLY & INSTALLATION INSTRUCTIONS
UNITED STATES ENGLISH

RAVELLE PENDANT 10"

PARTS INCLUDED

- (A) Mounting Strap (1)
- (B) Mounting Loop (1)
- (C) Mounting Screws (2)
- (D) 18" Connection Rods (2)
- (E) Canopy (1)
- (F) Canopy Ring (1)
- (G) 6" Connection Rods (2)
- (H) 12" Connection Rods (2)
- (I) Connectors (5)
- (J) Screws (8)
- (K) Plastic Washers (8)
- (L) Glass Ring (1)
- (M) Glass Cylinder (1)
- (N) Shade Holder (1)
- (O) Bulb (1)

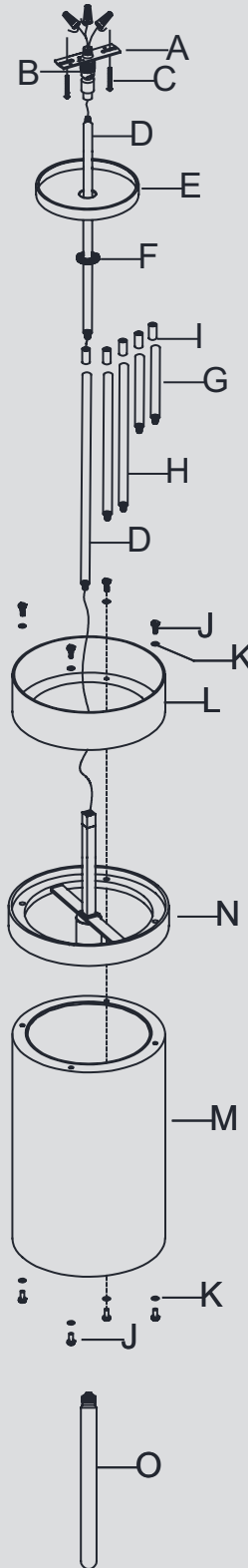

IMPORTANT: PLEASE READ

PLEASE FOLLOW THE ASSEMBLY INSTRUCTIONS CLOSELY. IMPROPER ASSEMBLY OR INSTALLATION CAN RESULT IN PERSONAL OR PROPERTY DAMAGE. MOUNTING HARDWARE HAS BEEN PROVIDED FOR MOUNTING DIRECTLY TO A JUNCTION BOX. UNIQUE OR ALTERNATIVE, INSTALLATION METHODS MAY REQUIRE DIFFERENT MOUNTING HARDWARE, WHICH HAS NOT BEEN INCLUDED. ALWAYS CONSULT WITH A LICENSED ELECTRICIAN BEFORE INSTALLATION.

INSTALLATION BY A LICENSED ELECTRICIAN IS STRONGLY RECOMMENDED.

IMPORTANT SAFETY FEATURES

BULBS

This fixture has been rated for one (1) 60-watt maximum Type T incandescent lightbulb or one (1) 13-watt maximum compact fluorescent bulb. To avoid the risk of fire, do not exceed the recommended wattage.

VAULTED-CEILING COMPATIBILITY

This fixture is vaulted-ceiling compatible, up to a maximum ceiling slope of 20 degrees.

DIMMER-SWITCH COMPATIBILITY

This fixture is dimmer-switch compatible, and may only be used with a forward-phase dimmer switch.

WARNINGS

All wires are connected. When unpacking, be careful not to pull wires, as damage may result. Do not connect electricity until the fixture is fully assembled. To reduce the risk of fire, electrical shock, or personal injury, always turn off fixture and allow it to cool prior to replacing the lightbulb. Do not touch or look directly at the bulb when fixture is illuminated. Keep flammable materials away from lit bulb.



WARNING: This product can expose you to lead, which is known to the State of California to cause cancer and birth defects or other reproductive harm. For more information, go to www.P65Warnings.ca.gov.

WARNING: STRANGULATION HAZARD

Keep cord at least 3 feet away from cribs, bassinets, and toddler beds. Keep out of reach of children under 3 years of age.

THIS PRODUCT IS NOT A TOY AND HAS NO PLAY VALUE.

ASSEMBLY AND INSTALLATION

SHUT OFF THE MAIN ELECTRICAL SUPPLY FROM THE FUSE BOX OR CIRCUIT BREAKER PANEL.

1. Carefully remove all parts from the box and remove all plastic coverings.
2. Remove Screws (J) and Plastic Washers (K) from Shade Holder (N). Attach Glass Ring (L) to the top of Shade Holder (N) and secure with Plastic Washers (K) and Screws (J).
3. Attach Glass Cylinder (M) to the bottom of Shade Holder (N). Secure with Plastic Washers (K) and Screws (J).
4. Determine the desired hanging length of pendant. Connect the center rod from Shade Holder (N) to some or all Connection Rods (D) (G) (H) and Connectors (I) according to the height needed.
5. Feed wires through Connection Rods (D) (G) (H), Connectors (I) and Mounting Loop (B).
6. Unscrew Canopy Ring (F) from Mounting loop (B). Slide Canopy Ring (F) and Canopy (E) onto Connection Rod (D).
7. Screw Mounting Loop (B) onto the top nipple on Connection Rod (D) by turning in a clockwise direction.
8. Attach Mounting Strap (A) to the ceiling outlet box and secure with Mounting Screws (C).
9. Gently pull the wire from ceiling outlet box and allow the wire to hang. Thread the wire through the center hole of Mounting Loop (B).
10. Carefully inspect the pendant's two fixture wires. One has very fine ridges molded into the plastic covering – this is the neutral wire. The second wire's covering is smooth – this is the hot wire. The bare wire is the ground wire.
11. Connect the ground wire from the fixture with the ground wire (usually bare) from your ceiling box using a wire nut. If your house does not have ground wire, then attach the ground wire from the fixture to the green grounding screw inside of the outlet box. **IT IS IMPERATIVE THAT THE OUTLET BOX IN YOUR HOME BE PROPERLY GROUNDED.**
12. Connect the neutral wire from your fixture with the neutral wire (usually white) from your ceiling box using a wire nut.

RAVELLE PENDANT 10" UNITED STATES ENGLISH

13. Connect the hot wire from your fixture with the hot wire (usually black) from your outlet box using a wire nut. DO NOT REVERSE THE HOT AND NEUTRAL CONNECTIONS OR SAFETY WILL BE COMPROMISED.
14. Raise Canopy (E) to the affixed Mounting Strap (A) and secure with Canopy Ring (F).
15. Insert Bulb (O) into the socket.
16. Restore power to outlet box and check operation of fixture.
17. Assembly is complete.

CARE INSTRUCTIONS

Do not use polishes or cleaners on the fixture. Wipe clean with a soft, dry cloth.

HEIGHT ADJUSTMENT INSTRUCTIONS

1. Feed the wires through Connection Rod (D), then thread Connection Rod (D) to the rod on Shade Holder (N).
2. Feed the wires through Connection Rod (H), then thread Connection Rod (H) to Connection Rod (D).
3. Feed the wires through Connection Rod (G), then thread Connection Rod (G) to Connection Rod (H).

