

# KENNAN TAPERED PENDANT 14", 18"

ASSEMBLY AND INSTALLATION INSTRUCTIONS

**ENGLISH**

**KENNAN TAPERED PENDANT 14", 18"**

**PARTS INCLUDED**

- (A) Wire Nuts (3)
- (B) Mounting Strap (1)
- (C) Mounting Screws (2)
- (D) Mounting Loop (1)
- (E) Canopy (1)
- (F) Collar Ring (1)
- (G) 6" Connection Rods (2)
- (H) 12" Connection Rods (2)
- (I) 18" Connection Rods (2)
- (J) Couplings (5)
- (K) Socket (1)
- (L) Shade (1)
- (M) Thumbscrews (3)
- (N) Metal Cap (1)
- (O) Socket Sleeve (1)
- (P) Bulb (1)
- (Q) Glass Shade (1)

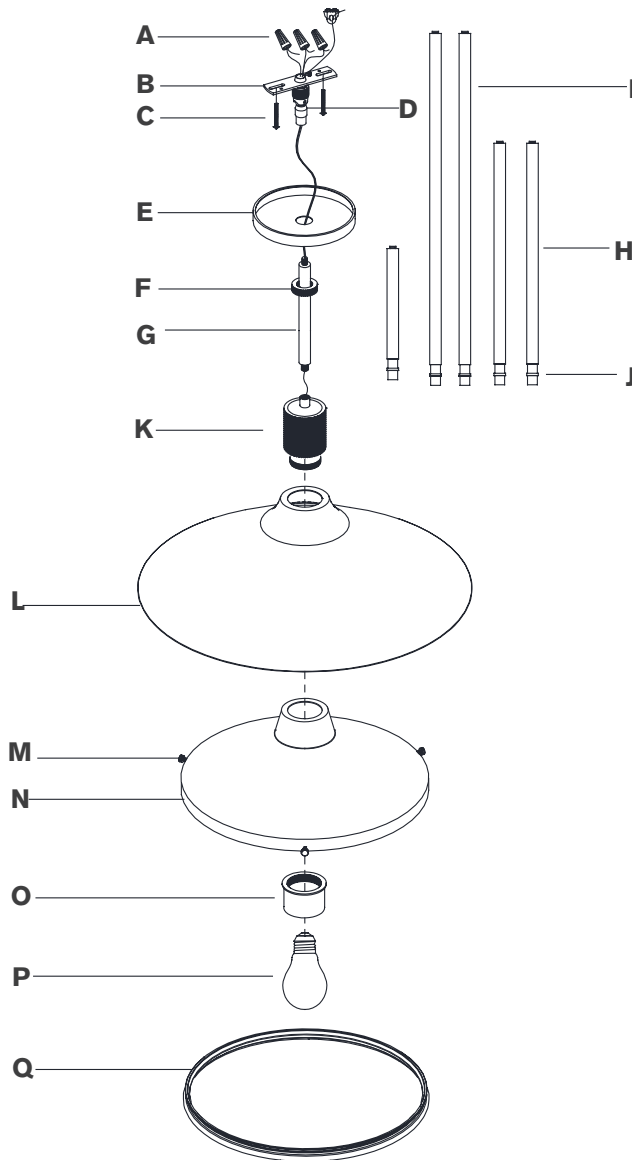

**IMPORTANT: PLEASE READ**

**PLEASE FOLLOW THE ASSEMBLY INSTRUCTIONS CLOSELY. IMPROPER ASSEMBLY OR INSTALLATION CAN RESULT IN PERSONAL OR PROPERTY DAMAGE. MOUNTING HARDWARE HAS BEEN PROVIDED FOR MOUNTING DIRECTLY TO A JUNCTION BOX. UNIQUE OR ALTERNATIVE INSTALLATION METHODS MAY REQUIRE DIFFERENT MOUNTING HARDWARE, WHICH HAS NOT BEEN INCLUDED. ALWAYS CONSULT WITH A LICENSED ELECTRICIAN BEFORE INSTALLATION.**

**INSTALLATION BY A LICENSED ELECTRICIAN IS STRONGLY RECOMMENDED.**

**IMPORTANT SAFETY FEATURES**

**BULBS**

This fixture has been rated for one (1) 60-watt maximum Type A incandescent lightbulb or one (1) 9-watt maximum LED lightbulb. To avoid the risk of fire, do not exceed the recommended wattage.

**VAULTED CEILING COMPATIBILITY**

This fixture is vaulted-ceiling compatible, up to a maximum ceiling slope of 20 degrees.

**DIMMER SWITCH COMPATIBILITY**

This lamp is dimmer-switch compatible and may be used with either a forward-phase or reverse-phase dimmer switch.

**WARNINGS**

All wires are connected. When unpacking, be careful not to pull wires, as damage may result. Do not connect electricity until the fixture is fully assembled. To reduce the risk of fire, electrical shock, or personal injury, always turn off fixture and allow it to cool prior to replacing the lightbulb. Do not touch or look directly at the bulb when fixture is illuminated. Keep flammable materials away from lit bulb.



**WARNING:** This product can expose you to chemicals including lead, which is known to the State of California to cause cancer and birth defects or other reproductive harm.

For more information, go to [www.P65Warnings.ca.gov](http://www.P65Warnings.ca.gov).

**WARNING: STRANGULATION HAZARD**

Keep cord at least 3 feet away from cribs, bassinets, and toddler beds. Keep out of reach of children under 3 years of age.

**THIS PRODUCT IS NOT A TOY AND HAS NO PLAY VALUE.**

**INSTALL SAFETY CABLE:**

1. Run safety cable through junction box and around structural member of building.
2. Wrap the safety cable around the saddle (a), and secure with u-bolt (b) and hex nuts (c).

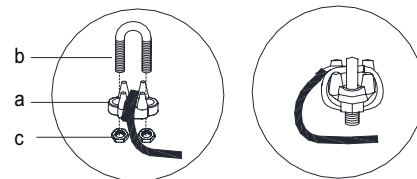

**ASSEMBLY AND INSTALLATION****SHUT OFF THE MAIN ELECTRICAL SUPPLY FROM THE FUSE BOX OR CIRCUIT BREAKER PANEL.**

1. Carefully remove all parts from the box and remove all plastic coverings. Place on a clean, soft surface.
2. According to the hanging height, feed fixture wires through some or all Connection Rods (G) (H) (I) and Couplings (J).
3. According to the hanging height, connect some or all Connection Rods (G) (H) (I) and Couplings (J) to the top of Socket (K).
4. Remove Collar Ring (F) from Mounting Loop (D), slide Collar Ring (F) and Canopy (E) down and rest on the top of Socket (K).  
NOTE: Slide components down slowly to avoid damages.
5. Screw Mounting Loop (D) to the inner rod of Connection Rod (G), (H) or (I).
6. Install Mounting Strap (B) to junction box and secure with Mounting Screws (C).
7. Connect the safety cable as shown in the diagram on the previous page.
8. Wrap fixture ground wire (bare copper) around the green grounding screw and tighten. Continue feeding fixture ground wire and connect to supply ground wire (usually green or bare copper) using a Wire Nut (A). NOTE: It is imperative that the fixture is grounded.
9. Connect fixture neutral wire (ribbed) to the supply neutral wire (usually white) using a Wire Nut (A).
10. Connect fixture hot wire (smooth with marking) to the supply hot wire (usually black) using a Wire Nut (A). CAUTION: Do not reverse the hot and neutral connections.
11. Make sure all wire connections are tight, then carefully tuck into the junction box.
12. Install Canopy (E) to Mounting Strap (B) and secure with Collar Ring (F).
13. Remove Socket Sleeve (O) from Socket (K), install Shade (L) and Metal Cap (N) to the Socket (K) and secure with Socket Sleeve (O).
14. Install Bulb (P) into the socket.
15. Loosen Thumbscrews (M), install Glass Shade (Q) to Metal Cap (N) and secure with Thumbscrews (M).  
Note: Do not overtighten otherwise glass could become damage.
16. Installation is complete. Turn on power at fuse or circuit breaker.
17. Assembly is complete.

**CARE INSTRUCTIONS**

Do not use polishes or cleaners on the fixture. Wipe clean with a soft, dry cloth.