

FULCRUM PENDANT 13"

PARTS ENCLOSED

- (A) Mounting Plate (1)
- (B) Collar Loop (1)
- (C) Mounting Screws (2)
- (D) Canopy (1)
- (E) Collar Ring (1)
- (F) 18" Connection Rods (2)
- (G) 12" Connection Rods (2)
- (H) 6" Connection Rods (2)
- (I) Cap (1)
- (J) Knurled Ring (1)
- (K) Socket Cover (1)
- (L) Outer Glass Shade (1)
- (M) Ring (1)
- (N) Inner Glass Shade (1)
- (O) Socket Ring (1)
- (P) Bracket (1)
- (Q) Bulb (1)

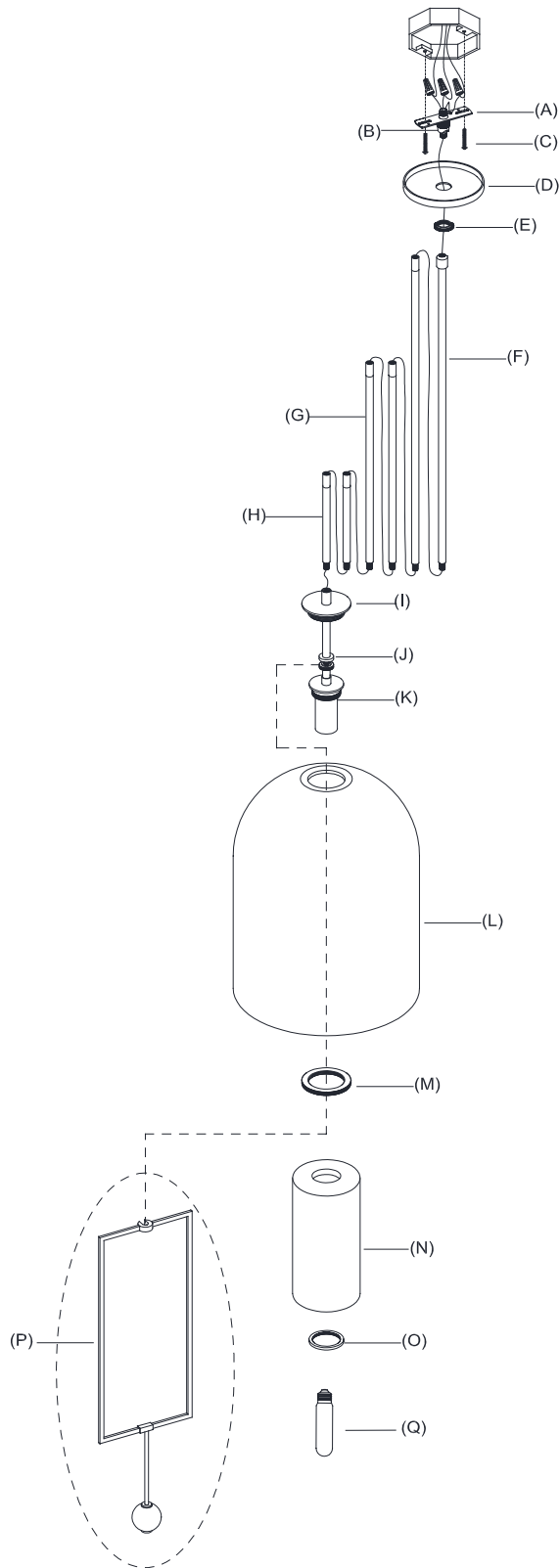

FULCRUM PENDANT 13"

IMPORTANT SAFETY INSTRUCTIONS

INSTALLATION BY A LICENSED ELECTRICIAN IS STRONGLY RECOMMENDED.

This fixture has been rated for three (3) 60-watt maximum Type T lightbulbs (25W lightbulb included) or three (3) 13-watt compact fluorescent lightbulbs (not included). To avoid the risk of fire, do not exceed the recommended wattage.

WARNINGS

All wires are connected. When unpacking, be careful not to pull wires, as a bad connection may result. Do not connect electricity until your fixture is fully assembled. To reduce the risk of fire, electrical shock, or personal injury, always turn off fixture and allow it to cool prior to replacing the lightbulb. Do not touch or look directly at the bulb when fixture is illuminated. Keep flammable materials away from lit bulb.



WARNING: This product can expose you to lead, which is known to the State of California to cause cancer and birth defects or other reproductive harm. For more information, go to www.P65Warnings.ca.gov.

THIS PRODUCT IS NOT A TOY AND HAS NO PLAY VALUE.



WARNING: STRANGULATION HAZARD

Keep cord at least 3 feet away from cribs, bassinets, and toddler beds. Keep out of reach of children under 3 years of age.

ASSEMBLY & INSTALLATION

SHUT OFF THE MAIN ELECTRICAL SUPPLY FROM THE FUSE BOX OR CIRCUIT BREAKER PANEL.

1. Carefully remove all parts from the box and remove all plastic coverings.
2. Feed the wires through Connection Rods (F) (G) (H). Screw Connection Rods (F) (G) (H) to the middle of Cap (I) according to the height needed.

ASSEMBLY & INSTALLATION CONT.

3. Loosen Collar Ring (E). Slide Collar Ring (E) and Canopy (D) down on Connection Rods (F) (G) (H). Note: Slide the components down slowly to avoid damage.
4. Screw Collar Loop (B) to the connector on the top Connection Rods (F) (G) (H).
5. Attach Mounting Strap (A) to the ceiling outlet box and secure with Mounting Screws (B).
6. Wrap fixture ground wire (bare copper) around the green grounding screw on Mounting Strap (A) and connect to ground wire (usually green or bare copper) from the outlet box using a wire nut. NOTE: It is imperative that the fixture is grounded.
7. Connect fixture neutral wire (ribbed) to the outlet box neutral wire (usually white) using a wire nut.
8. Connect the fixture hot wire (smooth with markings) to the outlet box hot wire (usually black) using a wire nut. CAUTION: Do not reverse the hot and neutral connections.
9. Attach Canopy (D) with the fixture body to the affixed Mounting Strap (A) and secure with Collar Ring (E).
10. Remove Ring (M) from Cap (I). Attach Outer Glass Shade (L) to Cap (I) and secure with Collar Ring (M).
11. Attach Bracket (P) to the top of Socket Cover (K) and secure with Knurled Ring (J).
12. Remove Socket Ring (O) from Socket Cover (K). Attach Inner Glass Shade (N) to Socket Cover (K) and secure with Socket Ring (O).
13. Insert Bulb (Q) into the socket.
14. Restore power to outlet box and check operation of fixture.
15. Assembly is complete.

CARE INSTRUCTIONS

Do not use polishes or cleaners on the fixture. Wipe clean with a soft, dry cloth.

FULCRUM PENDANT 15"

PARTS ENCLOSED

- (A) Mounting Plate (1)
- (B) Collar Loop (1)
- (C) Mounting Screws (2)
- (D) Canopy (1)
- (E) Collar Ring (1)
- (F) 18" Connection Rods (2)
- (G) 12" Connection Rods (2)
- (H) 6" Connection Rods (2)
- (I) Cap (1)
- (J) Knurled Ring (1)
- (K) Socket Cover (1)
- (L) Outer Glass Shade (1)
- (M) Ring (1)
- (N) Inner Glass Shade (1)
- (O) Socket Ring (1)
- (P) Bracket (1)
- (Q) Bulb (1)

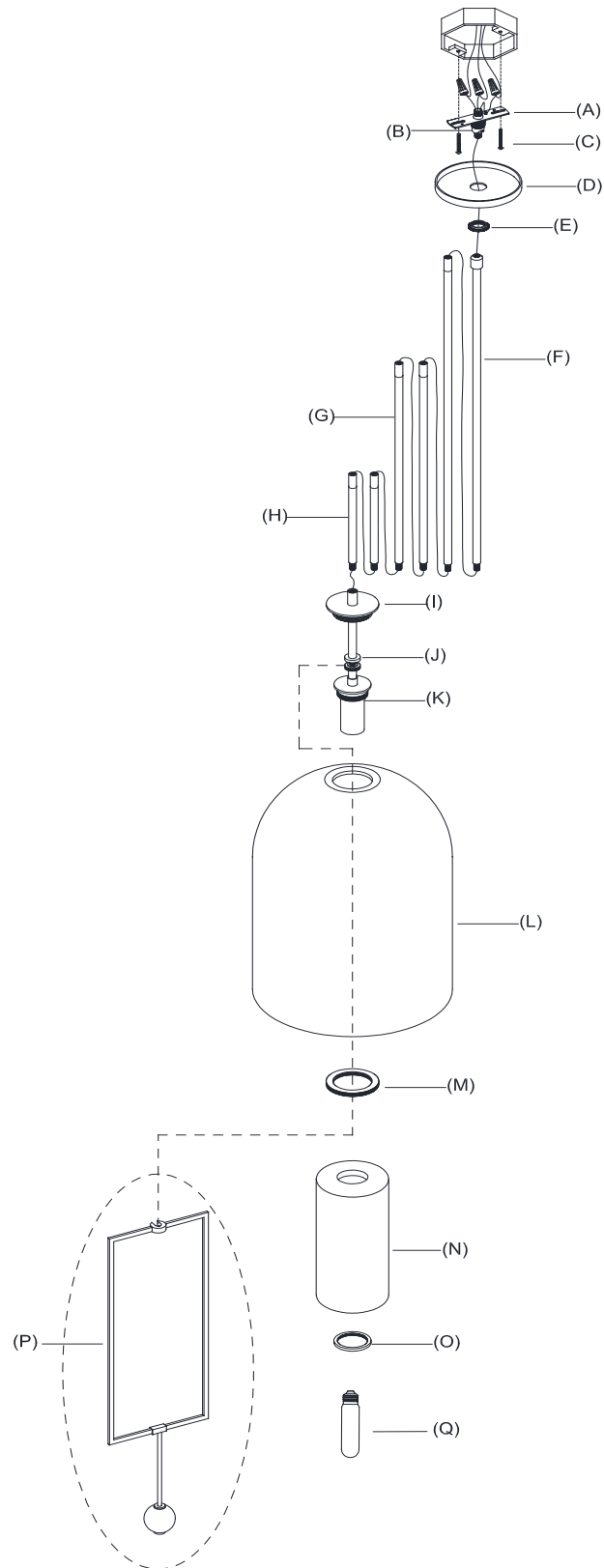

FULCRUM PENDANT 15"

IMPORTANT SAFETY INSTRUCTIONS

INSTALLATION BY A LICENSED ELECTRICIAN IS STRONGLY RECOMMENDED.

This fixture has been rated for three (3) 60-watt maximum Type T lightbulbs (included) or three (3) 13-watt compact fluorescent lightbulbs (not included). To avoid the risk of fire, do not exceed the recommended wattage.

WARNINGS

All wires are connected. When unpacking, be careful not to pull wires, as a bad connection may result. Do not connect electricity until your fixture is fully assembled. To reduce the risk of fire, electrical shock, or personal injury, always turn off fixture and allow it to cool prior to replacing the lightbulb. Do not touch or look directly at the bulb when fixture is illuminated. Keep flammable materials away from lit bulb.



WARNING: This product can expose you to lead, which is known to the State of California to cause cancer and birth defects or other reproductive harm. For more information, go to www.P65Warnings.ca.gov.

THIS PRODUCT IS NOT A TOY AND HAS NO PLAY VALUE.



WARNING: STRANGULATION HAZARD

Keep cord at least 3 feet away from cribs, bassinets, and toddler beds. Keep out of reach of children under 3 years of age.

ASSEMBLY & INSTALLATION

SHUT OFF THE MAIN ELECTRICAL SUPPLY FROM THE FUSE BOX OR CIRCUIT BREAKER PANEL.

1. Carefully remove all parts from the box and remove all plastic coverings.
2. Feed the wires through Connection Rods (H) (G) (F). Screw Connection Rods (H) (G) (F) to the middle of Cap (I) according to the height needed.

ASSEMBLY & INSTALLATION CONT.

3. Loosen Collar Ring (E). Slide Collar Ring (E) and Canopy (D) down on Connection Rods (H) (G) (F). Note: Slide components down slowly to avoid damage.
4. Screw Collar Loop (B) to the connector on rod (F).
5. Attach mounting strap (A) to the ceiling outlet box and secure with Mounting Screws (B).
6. Wrap fixture ground wire (bare copper) around the green grounding screw on Mounting Strap (A) and connect to ground wire (usually green or bare copper) from the outlet box using a wire nut. NOTE: It is imperative that the fixture is grounded.
7. Connect fixture neutral wire (ribbed) to the outlet box neutral wire (usually white) using a wire nut.
8. Connect the fixture hot wire (smooth with markings) to the outlet box hot wire (usually black) using wire nut. CAUTION: Do not reverse the hot and neutral connections.
9. Attach Canopy (D) with the fixture body to the affixed Mounting Strap (A) and secure with Collar Ring (E).
10. Remove Ring (M) from Cap (I). Attach Outer Glass Shade (L) to Cap (I) and secure with Collar Ring (M).
11. Attach Bracket (P) to the top of Socket Cover (K) and secure with Knurled Ring (J).
12. Remove Socket Ring (O) from Socket Cover (K). Attach Inner Glass Shade (N) to Socket Cover (K) and secure with Socket Ring (O).
13. Insert Bulb (Q) into the socket.
14. Restore power to outlet box and check operation of fixture.
15. Assembly is complete.

CARE INSTRUCTIONS

Do not use polishes or cleaners on the fixture. Wipe clean with a soft, dry cloth.