



ARNAUD FLUSHMOUNT

ASSEMBLY & INSTALLATION INSTRUCTIONS

UNITED STATES ENGLISH

ARNAUD FLUSHMOUNT**PARTS INCLUDED**

- (A) Mounting Plate (1)
- (B) Canopy (1)
- (C) Lightbulbs (8)
- (a) Plastic Wire Connectors (3)
- (b) Green Ground Screw (1)
- (c) Mounting Screws (2)
- (d) Canopy Screws (3)
- (e) Allen Wrench (1)

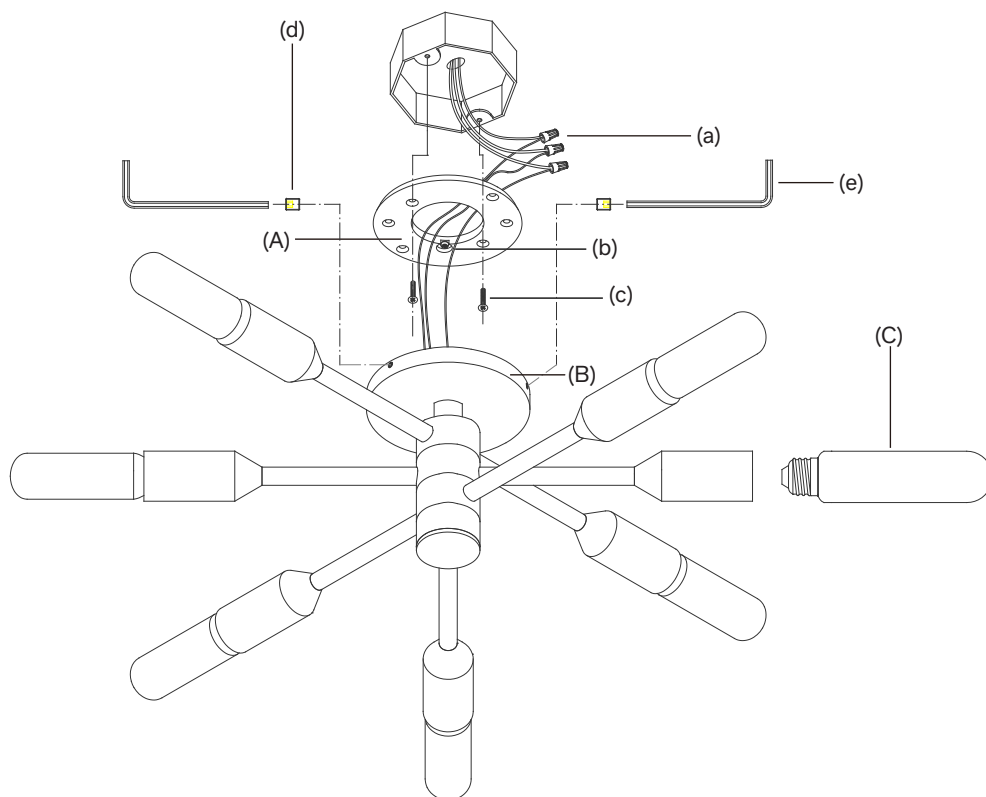

IMPORTANT: PLEASE READ

PLEASE FOLLOW THE ASSEMBLY INSTRUCTIONS CLOSELY. IMPROPER ASSEMBLY OR INSTALLATION CAN RESULT IN PERSONAL OR PROPERTY DAMAGE. MOUNTING HARDWARE HAS BEEN PROVIDED FOR MOUNTING DIRECTLY TO A JUNCTION BOX. UNIQUE OR ALTERNATIVE INSTALLATION MAY REQUIRE DIFFERENT MOUNTING HARDWARE, WHICH HAS NOT BEEN INCLUDED. ALWAYS CONSULT WITH A LICENSED ELECTRICIAN BEFORE INSTALLATION.

INSTALLATION BY A LICENSED ELECTRICIAN IS STRONGLY RECOMMENDED.

IMPORTANT SAFETY FEATURES**BULBS**

This fixture has been rated for up to (8) 60-watt maximum Type T incandescent lightbulbs or up to (8) 5-watt maximum LED lightbulbs. To avoid the risk of fire, do not exceed the recommended wattage.

VAULTED-CEILING COMPATIBILITY

This fixture is vaulted-ceiling compatible, up to a maximum ceiling slope of 60 degrees.

DIMMER-SWITCH COMPATIBILITY

This fixture is dimmer-switch compatible, and may only be used with a forward-phase dimmer switch.

WARNINGS

All wires are connected. When unpacking, be careful not to pull wires, as damage may result. Do not connect electricity until the fixture is fully assembled. To reduce the risk of fire, electrical shock, or personal injury, always turn off fixture and allow it to cool prior to replacing the lightbulbs. Do not touch or look directly at the bulbs when fixture is illuminated. Keep flammable materials away from lit bulbs.

WARNING: STRANGULATION HAZARD

Keep cord at least 3 feet away from cribs, bassinets, and toddler beds. Keep out of reach of children under 3 years of age.

THIS PRODUCT IS NOT A TOY AND HAS NO PLAY VALUE.

ASSEMBLY AND INSTALLATION**SHUT OFF THE MAIN ELECTRICAL SUPPLY FROM THE FUSE BOX OR CIRCUIT BREAKER PANEL.**

1. Carefully remove all parts from the box and remove all plastic coverings. Take care not to lose any small parts.
2. Turn off power at the outlet box where the fixture will be installed.
3. Attach the Mounting Plate (A) to the outlet box using the Mounting Screws (c) and tighten with a screwdriver.
4. While holding the fixture, connect the black wire from fixture to the hot wire (usually black or smooth) from the outlet box using a Plastic Wire Connector (a) and wrap the connection with the electrical tape. Connect the white wire from fixture to the neutral wire (usually white or ribbed) from the outlet box using a Plastic Wire Connector (a) and wrap the connection with the electrical tape. DO NOT REVERSE THE HOT AND NEUTRAL WIRE CONNECTIONS OR SAFETY WILL BE COMPROMISED.
5. If the outlet box has a ground wire (green or bare copper), connect it to the green ground wire from the fixture using a Plastic Wire Connector (a). If the outlet box does not have a ground wire, connect the green ground wire from the fixture to the Green Ground Screw (b) provided on the Mounting Plate (A).
6. Tuck all the wire connections neatly into the ceiling outlet box. Place the Canopy (B) over the Mounting Plate (A) and tighten the Canopy (B) with Canopy Screws (d) by using the Allen Wrench (e).
7. Insert the Lightbulbs (C) into sockets.
8. Installation is complete. Restore power at the circuit breaker or fuse box. Turn on the light switch to activate the fixture.

ATTENTION: ADJUSTING THE HANG HEIGHT

Any adjustments or alterations to the fixture, cord, or overall hang height that differ from those detailed on RH.com will void the Laboratory Listing and Approvals (UL, ETL, CSA, etc.). If the listing is voided, this means the product may no longer be safe for use as modified. RH does not recommend modifying the product.

CARE INSTRUCTIONS

Do not use polishes or cleaners on the fixture. Wipe clean with a soft, dry cloth.