

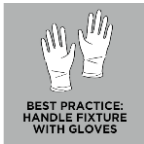

# MAYBECK 21 PENDANT

AKPD241WD

## General Product Information

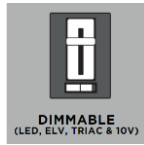
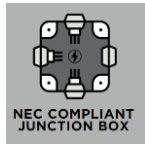
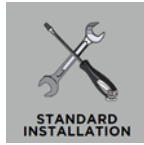

## Suggested/Required Tools



## Safety Information

### CAUTION-RISK OF FIRE

This product must be installed in accordance with the applicable installation code by a person familiar with the construction and operation of the product and the hazards involved.

**USE MINIMUM 90°C SUPPLY CONDUCTORS.**



Turn off electrical current at the source before working with any lighting fixture or portable lamp.

Install and use this product in adherence with local electrical codes and regulations.



**FIXTURE PARTS**

- A. Junction box
- B. Wire Nut Connections
- C. Driver
- D. Cable Grip with Set Screw (Not Illustrated)
- E. Mounting Bracket with Optional Spacers
- F. Mounting Screws
- G. Self-Drilling Anchors
- H. Anchor Screws
- I. Washers
- J. Half Ball
- K. Canopy Extender
- L. Canopy
- M. Collar Nut
- N. Stem Assembly (Long & Short Stems)
- O. Fixture
- P. Integrated LEDs
- Q. Glass Shade Panels

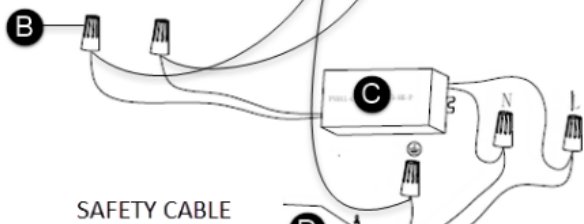
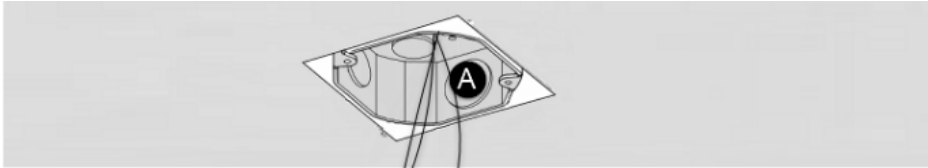

SAFETY CABLE

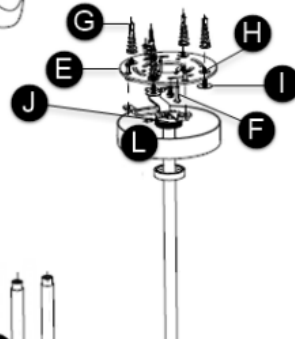

**Please Note:** It is best to have a second person assist with both installation options described in this install guide.

The **canopy extender** is optional (used for hiding the driver inside the canopy, if needed). If used with the fixture, assemble it along with the fixture parts.

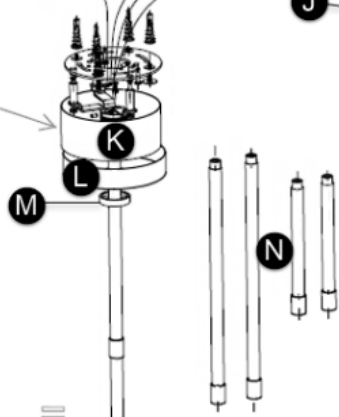

Optional **spacers** (included) can be added to the bracket to fit the driver, if needed.

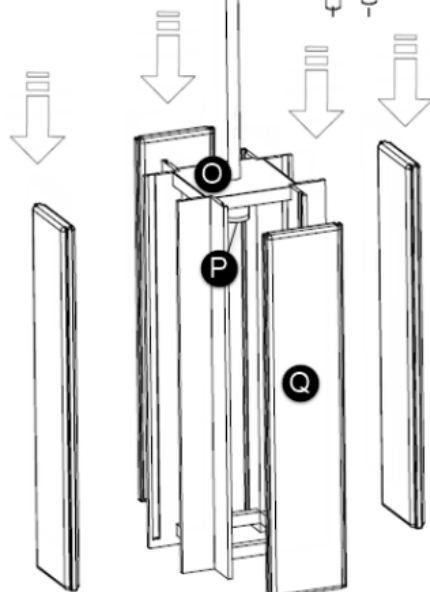
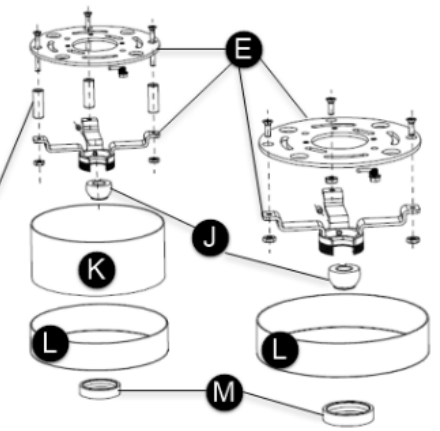

## **INSTRUCTIONS** (Option 1: Installation with Driver in Junction Box)

### **I. Preparing the Fixture**

1. Unbox and inspect all items included in the fixture's packaging. Handle the glass shade panels with care to prevent damage.
2. If necessary, separate the mounting bracket from the canopy by removing the collar nut.
3. Use the mounting bracket to trace and mark the locations for the self-drilling anchors. Drill holes at the marked locations to fit the anchors, then drive the anchors fully in.
4. Determine the height for the fixture and complete the stem assembly by screwing the long and short stems together to the desired length.
5. Feed the fixture wires and safety cable through the stem assembly, collar nut, canopy, and half ball.
6. Screw the stem assembly onto the top of the fixture, followed by screwing the half ball onto the top of the stem assembly.

### **II. Wiring & Installing the Fixture**

1. Safety first! Locate the circuit breaker and switch it off to cut off the power supply to the relevant circuits to ensure there's no electricity running through the wiring.
2. Connect the LED driver input wires to the local power line wires. Twist the bare ends of the following pairs of wires together using a wire nut to secure a connection:
  - a) Neutral driver wire (white) to neutral power line wire
  - b) Hot driver wire (black) to hot power line wire
3. Place the driver in the junction box, ensuring the driver output wires are accessible.
4. Secure the mounting bracket to the junction box using the mounting screws. Then slide the washers onto the anchor screws and tighten them into the anchors to secure the mounting bracket directly to the ceiling.
5. Slide the half ball assembly onto the mounting bracket.
6. Pull the safety through the mounting bracket and cable grips, then secure it to the bracket with the set screw.
7. In accordance with local electrical codes, connect the fixture ground wire (bare copper or silver wire) to suitable ground. This may be a green ground screw on the mounting plate, which the ground wire should be tightly wrapped around or a house wire (green or bare copper wire without insulation).
8. Now, twist the bare ends of the following pairs of wires together using a wire nut to secure a connection:
  - a) Negative/blue (-) fixture wire to negative/black (-) output driver wire
  - b) Positive/red (+) fixture wire to positive/red (+) output driver wire
8. Pull the safety cable through the mounting bracket and cable grips, then secure it to the bracket using the set screw.
9. Carefully tuck all the wires behind the mounting bracket into the junction box.

## **INSTRUCTIONS** (Option 2: Installation with Driver in Mounting Bracket/Canopy)

### **I. Preparing the Fixture**

1. Unbox and examine all the items included in the fixture's packaging. Handle the glass shade panels with care to avoid damage.
2. If necessary, separate the mounting bracket from the canopy by removing the collar nut.
3. Unscrew the plate portion of the mounting bracket just enough to detach the plate from the bracket.
4. Slide the spacers behind the screws on the plate, and then tighten the screws back onto the bracket, ensuring the spacers stay in place.
5. Use the mounting bracket as a template to trace and mark the locations for the self-drilling anchors. Drill holes at the marked spots to fit the anchors, then install the anchors completely.
6. Secure the mounting bracket to the junction box using the mounting screws. Next, slide the washers onto the anchor screws and tighten them into the anchors to fasten the mounting bracket securely to the ceiling.
7. Determine the height for the fixture and complete the stem assembly by screwing the long and short stems together to the desired length.
8. Feed the fixture wires and safety cable through the stem assembly, collar nut, canopy, canopy extender, and half ball.
9. Finally, screw the stem assembly onto the top of the fixture, then screw the half ball onto the top of the stem assembly.

### **II. Wiring & Installing the Fixture**

1. Safety first! Locate the circuit breaker and switch it off to cut off the power supply to the relevant circuits, ensuring there is no electricity running through the wiring.
2. Slide the half ball assembly onto the mounting bracket.
3. In accordance with local electrical codes, connect the fixture ground wire (bare copper or silver wire) to a suitable ground. This may be a green ground screw on the mounting bracket, around which the ground wire should be tightly wrapped, or a house wire (green or bare copper wire without insulation).
4. Connect the LED driver input wires to the local power line wires. Twist the bare ends of the following pairs of wires together using a wire nut to secure the connection:
  - a) Neutral driver wire (white) to neutral power line wire
  - b) Hot driver wire (black) to hot power line wire
5. Place the driver in the mounting bracket/canopy, ensuring the output driver wires are accessible.
6. Now, twist the bare ends of the following pairs of wires together using a wire nut to secure the connection:
  - a) Negative/blue (-) fixture wire to negative/black (-) output driver wire
  - b) Positive/red (+) fixture wire to positive/red (+) output driver wire
7. Pull the safety cable through the mounting bracket and cable grips, then secure it to the bracket using the set screw.
8. Carefully tuck all the wires behind the mounting bracket and into the junction box.
9. Slide the canopy onto the mounting plate and secure it in place using the collar nut.
10. To complete the installation, insert the glass shade panels into the designated slots on all sides of the fixture.